

LINCOLN COUNTY CORNER REPORT
SILETZ INDIAN RESERVATION 43-1/2 MILE CORNER (06-09)
GCDB 0609421399
LINCOLN COUNTY GEODETIC CONTROL STATION 65COR
SHEET 1 OF 1

1887 JEFFERSON D. FENTON SILETZ INDIAN RESERVATION AND GLO CONTRACT 531
SET: POST, 4' LONG, 4" SQUARE, 24" IN THE GROUND, ON TOP OF 75' RISE, MARKED "SIR" ON SOUTH,
"1/2 M" ON WEST, AND "PL" ON NORTH FACES, FROM WHICH POST:
▪ 32" FIR MARKED "PL 1/2 M BT" BEARS N 25° E, 17 LINKS (11.2').
▪ 28" HEMLOCK MARKED "SIR 1/2 M BT" BEARS S 20° E, 17 LINKS (11.2').

1980 WESLEY E. SCHLENKER CS 9508

FOUND:

▪ ORIGINAL DOUGLAS FIR STUMP BEARS N 25° E, 11.22' (= GLO).
▪ ORIGINAL DECADENT HEMLOCK BLOW DOWN BEARS S 20° E, 11.22' (= GLO).
SET: 1-1/4" X 41" GALVANIZED IRON PIPE WITH BRASS CAP MARKED "1980 43 1/2 M S.I.R. L.F.CO.
LS1100", ON GENTLE NORTHEAST SLOPE, FROM PIPE:

NEW:

▪ 9" HEMLOCK SCRIBED "SIR 43 1/2M" WITH LEAD WASHER, SCREW NAIL, AND YELLOW ALUMINUM
SECTION MARKER PLATE BEARS S 10° W, 30.45'.
▪ 52" FIR STUMP, 7' TALL, SCRIBED "SIR RP" WITH LEAD WASHER, SCREW NAIL, AND YELLOW
ALUMINUM SECTION MARKER PLATE BEARS S 74° W, 9.25'.
▪ SALMON RIVER MAIN LINE ROAD BEARS WEST, 400'.
▪ POWER LINE, COURSE N 70° E, BEARS SOUTH, 350'.

1987 JAMES W. PROCHNAU CS 11862

FOUND: 2" BRASS CAP ON 1-1/4" GALVANIZED IRON PIPE 1-1/2' OUT OF THE GROUND, FROM WHICH:

▪ ROTTED FIR STUMP WITH LONGVIEW FIBER TAG BEARS N 25° E, 11.2'.
▪ 13" HEMLOCK WITH VISIBLE SCRIBE BEARS S 10° W, 30.4' (CS 9508 S 10° W, 30.45').
▪ 52" DOUGLAS FIR STUMP BEARS S 74° W, 9.2' (CS 9508 S 74° W, 9.25').

2008 LINCOLN COUNTY SURVEYOR'S OFFICE

FOUND: 1-1/4" OUTSIDE DIAMETER GALVANIZED IRON PIPE 15" ABOVE GRADE WITH 2" BRASS CAP
MARKED "1980 43 1/2 M S.I.R. L.F.CO. LS1100", FROM WHICH:

▪ ORIGINAL 44" FIR STUMP 4' TALL, NO MARKS, BEARS N 25° E, 11.6' TO CENTER, 11.0' TO FACE
(GLO N 25° E, 11.2'). STUMP HAS A 9" HEMLOCK GROWING FROM THE NORTHWEST SIDE.
▪ NO EVIDENCE OF ORIGINAL SOUTHEAST BEARING TREE.
▪ ROTTED 16" HEMLOCK STUMP 2-1/2' TALL WITH PARTLY HEALED BLAZE AND SCRIBING "43 1/2 M
BT" AND ILLEGIBLE 3/4" LEAD WASHER, BEARS S 0° W, 31.0' TO CENTER, 30.0' TO FACE (CS 9508 S
10° W, 30.45').
▪ 52" PARTLY ROTTED FIR STUMP 6' TALL WITH SCRIBING "SIR BT" AND ILLEGIBLE 3/4" LEAD
WASHER PLUS LONGVIEW FIBER LOCATOR TAG MARKED "15/22 N 74° E, 9.25' " BEARS S 74° W,
9.25' (= CS9508).

NEW:

▪ 5/8" X 30" REBAR WITH 2" LINCOLN COUNTY ALUMINUM CAP MARKED "65AZ" BEARS N 71°23'15" E,
279.05'.
▪ 6" FIR SCRIBED "SIR 43 1/2 M" "BT" IN DOUBLE BLAZE BEARS S 24° W, 9.1'.
▪ CARSONITE POST 3' NORTH.
▪ REPAINTED FACES OF FOUND BEARING TREES.

CONCLUSION THE PIPE FOUND IS THAT SET BY PROCHNAU IN 1984 AND IS A PERPETUATION OF THE
1887 FENTON POSITION.

NEW BEARING TREES HAVE LINCOLN COUNTY SURVEY MARKER TAGS, A 3/4" BRASS WASHER
MARKED "LINCOLN CO.", AND 6" RED PAINTED BANDS 6' ABOVE GRADE.

MEASUREMENTS WERE DONE WITH A LEICA TCA1105 TOTAL STATION, POCKET COMPASS AND
STEEL TAPE. BEARINGS ARE GEODETIC, BASED UPON STARNET PROJECT 6-9.PRJ AND THE
MAPPING ANGLE OF -2°19'33" AT THE 43-1/2 MILE CORNER.

WITNESSES: PHIL LAMBERSON

LINCOLN COUNTY SURVEYOR'S OFFICE
880 NE 7TH ST.
NEWPORT, OREGON 97365
(541)-265-4147

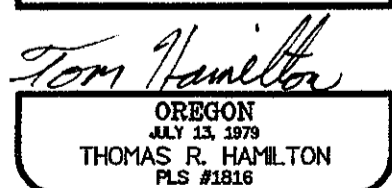
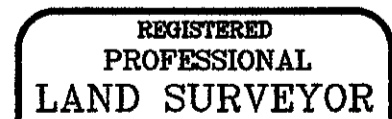
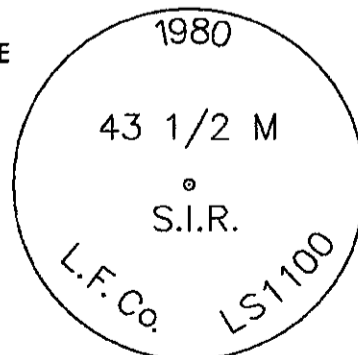

RENEWAL DATE: JUNE 30, 2009